

**A FRAMING SECTION**  
S3.2 3/4" = 1'-0"

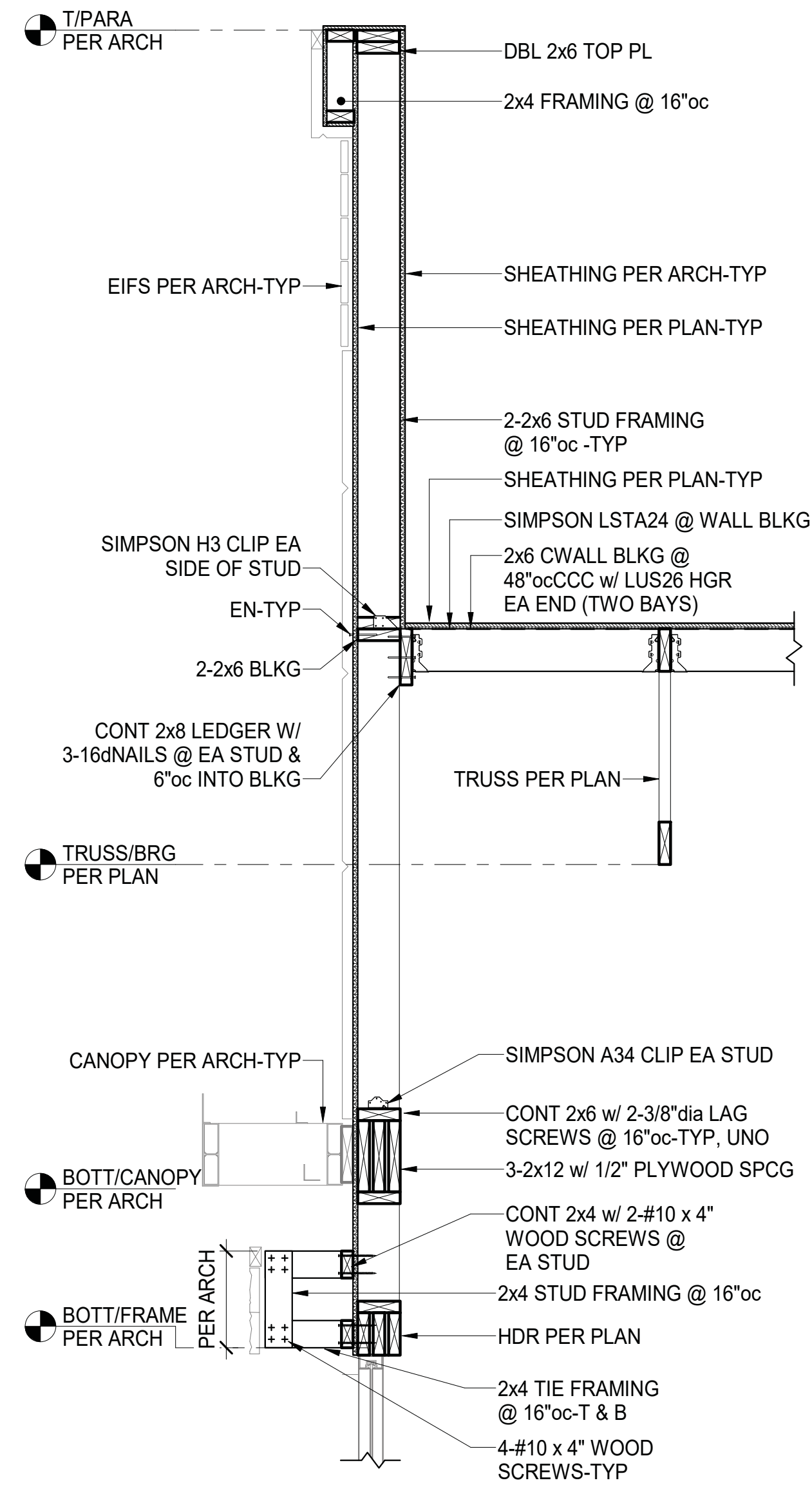

**B FRAMING SECTION**  
S3.2 3/4" = 1'-0"

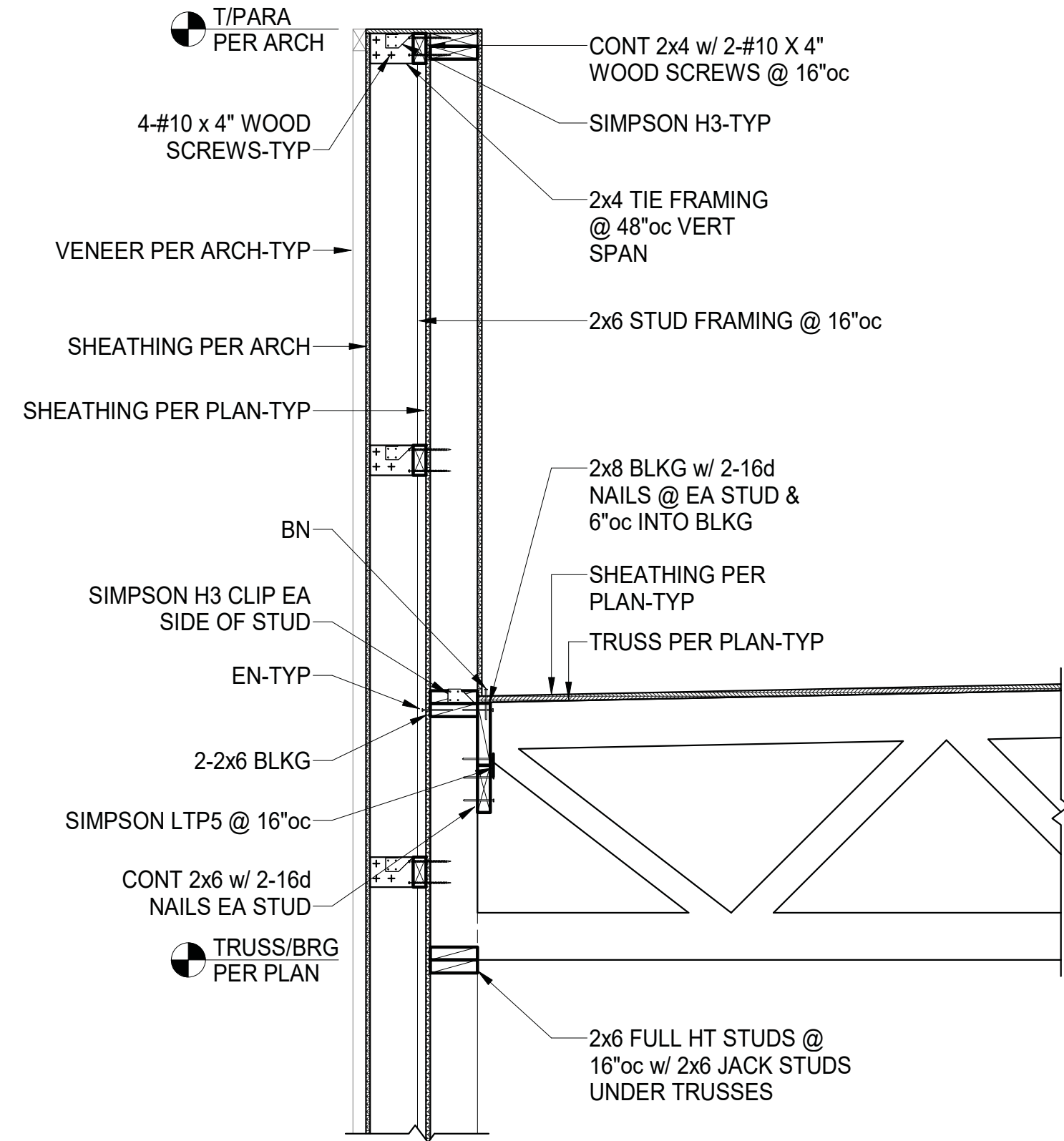

**C FRAMING SECTION**  
S3.2 3/4" = 1'-0"

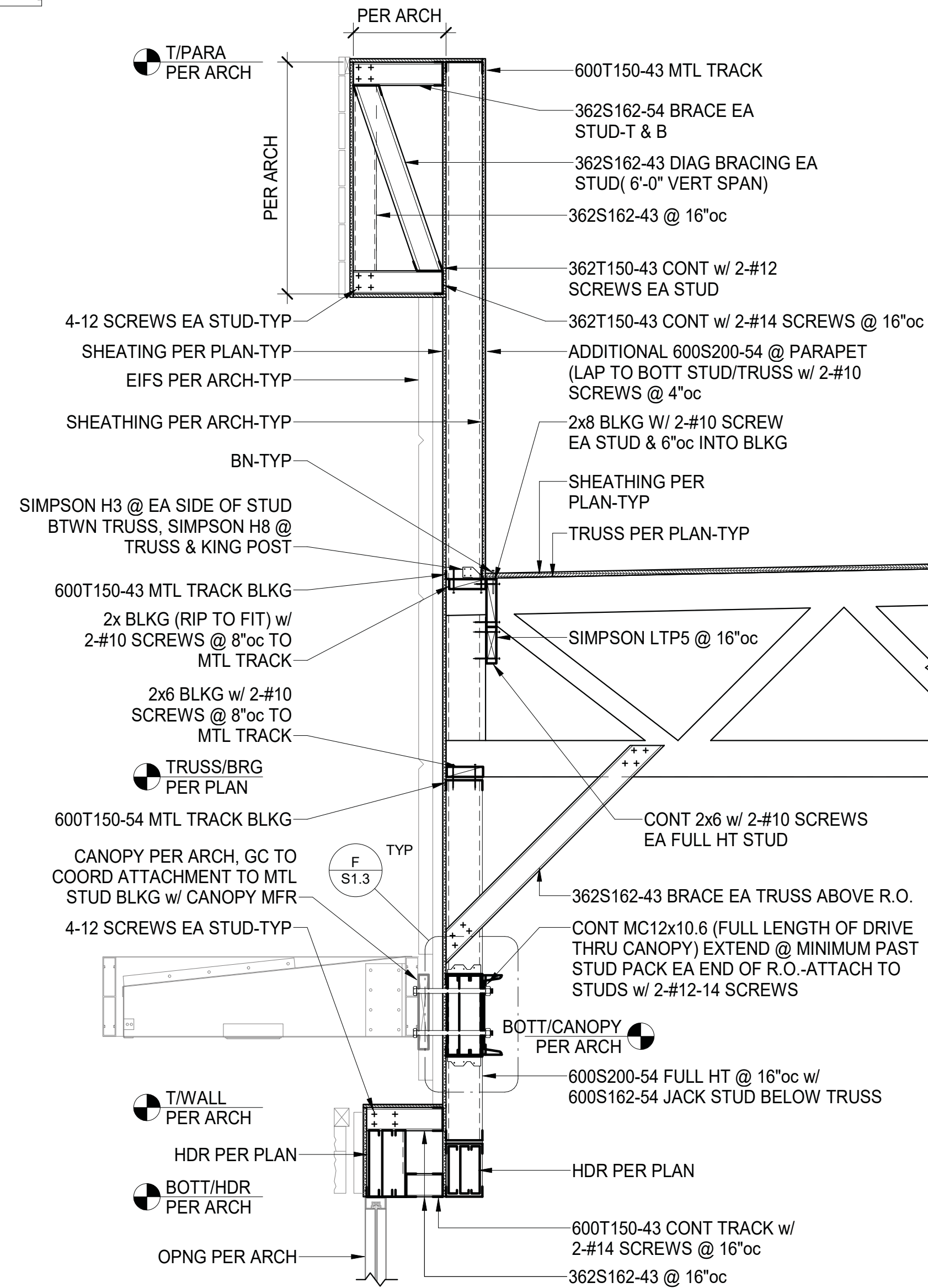

**D FRAMING SECTION**  
S3.2 3/4" = 1'-0"

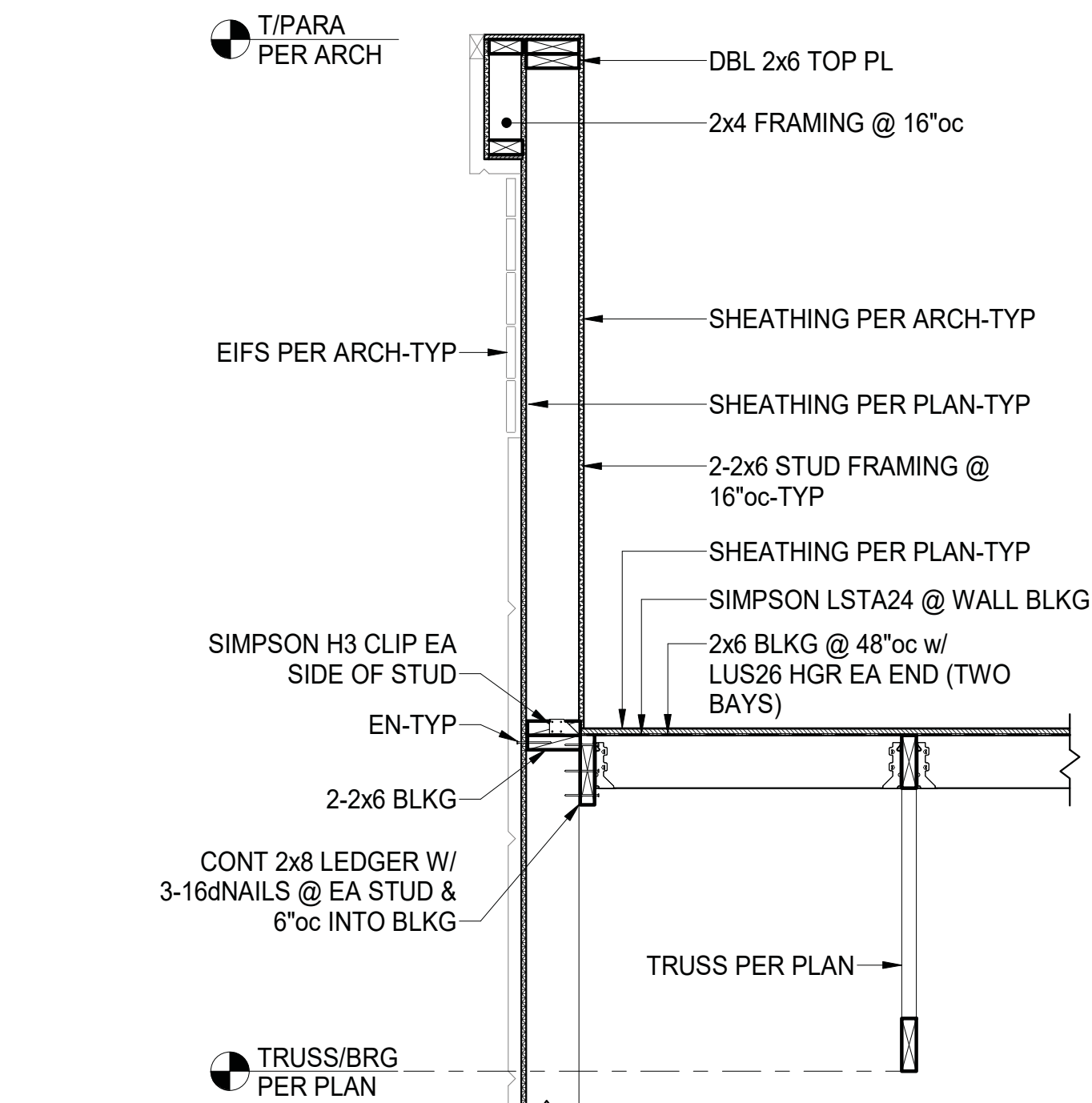

**E FRAMING SECTION**  
S3.2 3/4" = 1'-0"

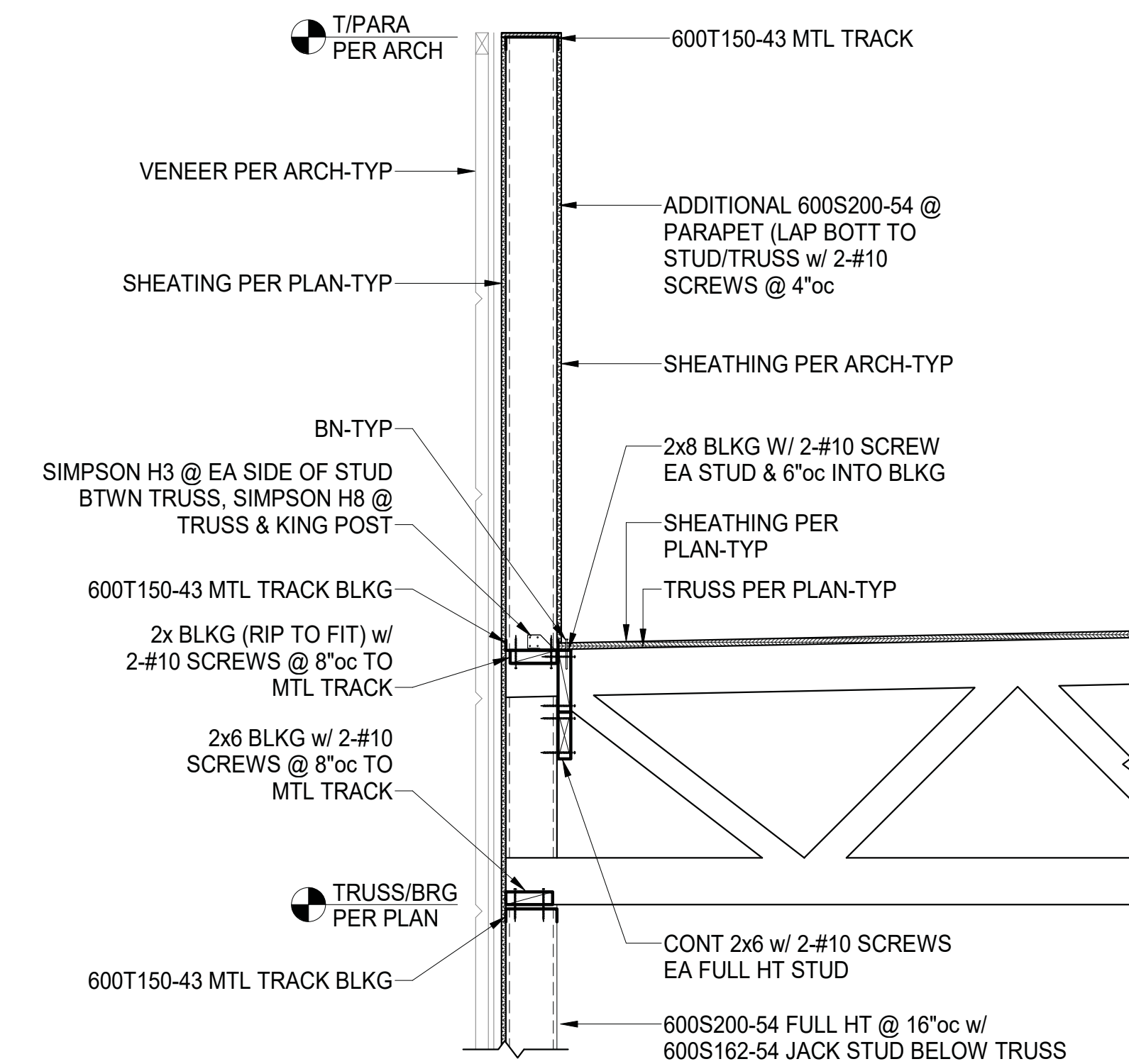

**F FRAMING SECTION**  
S3.2 3/4" = 1'-0"

MISSOURI  
**CASE**  
Engineering Inc.  
796 Merus Court  
St. Louis, MO 63026  
T 636.349.1600  
F 636.349.1730  
CERTIFICATE OF AUTHORITY NO. 201808201274213



PANDA EXPRESS, INC.  
1683 Walnut Grove Ave.  
Rosemead, California  
91770  
Telephone: 626.799.9898  
Facsimile: 626.372.8288

All ideas, designs, arrangement and plans indicated or represented by this drawing are the property of Panda Express Inc. and were created for use on this specific project. None of these ideas, designs, arrangements or plans may be used by or disclosed to any person, firm, or corporation without the written permission of Panda Express Inc.

ISSUE DATE:  
04/27/21 WALMART REVIEW  
05/05/21 ISSUE FOR PERMIT

DRAWN BY: DLP

PANDA PROJECT #: S8-22-D8044  
ENG PROJECT #: NEW-IN-01-21



15450 S OUTER FORTY DRIVE, SUITE 300  
CHESTERFIELD, MO 63017

**PANDA EXPRESS**  
TRUE WARM & WELCOME  
STATE ST. & NEW RD.  
GREENFIELD, IN 46140

**S3.2**

SECTIONS

TRUE WARM & WELCOME 2300 R4