

RECORD OF SURVEY No. 32-88

IN THE UNINCORPORATED TERRITORY OF THE COUNTY OF MONO, STATE OF CALIFORNIA,
BEING SECTIONS 4, 9, 10, AND 11, TOWNSHIP 6 NORTH, RANGE 23 EAST,
MOUNT DIABLO MERIDIAN

MONUMENT DESCRIPTIONS:

1114 FOUND A 1 INCH IRON PIPE AND TAG STAMPED "RCE 27104" PER R2, 2.5 INCHES ABOVE THE GROUND IN A COLLAR OF STONES, ALSO FOUND A "T" POST 0.5 FEET EASTERLY. FOUND SAID PIPE TO BE 0.10' (0.00' R2) NORTHERLY OF THE EAST-WEST CENTER SECTION LINE AND 800.10' (800.00' R2) WESTERLY FROM THE CENTER ¼ CORNER (440540) OF SECTION 10. LEFT SAID PIPE IN PLACE AND SET NOTHING.

1125 FOUND A 1 INCH IRON PIPE AND TAG STAMPED "RCE 27104" PER R2, FLUSH WITH THE GROUND IN A COLLAR OF STONES, ALSO FOUND A "T" POST WITH A 6 FOOT BY 2 INCH PVC SLEEVE 1.0 FOOT NORTHERLY. FOUND SAID PIPE TO BE 0.25' (0.00' R2) NORTHERLY OF THE SECTION LINE AND 282.16' (282.03' R2) EASTERLY FROM THE S ¼ CORNER (440500) OF SECTION 10. LEFT SAID PIPE IN PLACE AND SET NOTHING.

300500 THIS MONUMENT SET BY CONCURRENT SURVEY AND SHOWN ON RECORD OF SURVEY NO. 32-87, RECORD OF SURVEY MAPS BOOK 5, PAGE 11.

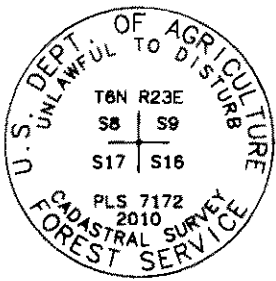

FOUND A 5/8 INCH RE-BAR WITH A 2 INCH ALUMINUM CAP STAMPED "LS 4587 1997" PER R3, ALSO FOUND THE ORIGINAL 4 FOOT LONG BY 4 INCH DIAMETER SCRIBED WOODEN POST LYING NEXT TO THE CAP. ACCEPTED SAID PIPE AS THE TRUE CORNER AND REPLACED WITH A STANDARD US FOREST SERVICE ALUMINUM MONUMENT WITH A 3¼ INCH DIAMETER ALUMINUM CAP, STAMPED AS SHOWN, ON A 2½ INCH DIAMETER POST, 30 INCHES LONG, 24 INCHES IN THE GROUND, ENCIRCLED BY A MOUND OF STONES, 3.0 FEET IN DIAMETER AND 6 INCHES ABOVE THE GROUND. PLACED A PLASTIC ENCASED MAGNET BENEATH THE MONUMENT. BURIED THE FOUND RE-BAR AND CAP UPSIDE DOWN ALONGSIDE THE NEW MONUMENT, LEFT ORIGINAL POST ON THE SURFACE LYING ALONGSIDE THE NEW MONUMENT. SET A U CHANNEL ALUMINUM POST WITH A FOREST SERVICE 54-9 MONUMENT SIGN, 1.5 FEET NORTHERLY. FOUND ORIGINAL BEARING TREE:

BT1: A 24 INCH JUNIPER, S22°E, 52.7 FEET

ADDED, TO BT1, A FOREST SERVICE 54-3 BEARING TREE SIGN AND A 6" MAG SPIKE AND "PLS 7172" STAINLESS STEEL WASHER FOR A CHAINING POINT AT BASE CENTER RIGHT SIDE. MADE A NEW BEARING TREE, BASE BLAZE SCRIBED "BT", WITH 6" MAG SPIKE AND "PLS 7172" STAINLESS STEEL WASHER FOR CHAINING POINT AT BASE CENTER RIGHT SIDE, AND FOREST SERVICE 54-3 BEARING TREE SIGN:

BT2: A 12 INCH JUNIPER, N58°E, 15.0 FEET

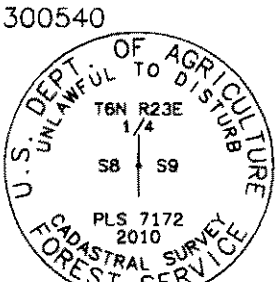

SEARCHED, FOUND NOTHING, ESTABLISHED BY SINGLE PROPORTION BETWEEN 300500 TO THE SOUTH AND 300600 TO THE NORTH, SET A STANDARD US FOREST SERVICE ALUMINUM MONUMENT WITH A 3¼ INCH DIAMETER ALUMINUM CAP, STAMPED AS SHOWN, ON A 2½ INCH DIAMETER POST, 30 INCHES LONG, 26 INCHES IN THE GROUND, ENCIRCLED BY A MOUND OF STONES, 2.0 FEET IN DIAMETER AND 4 INCHES ABOVE THE GROUND. PLACED A PLASTIC ENCASED MAGNET BENEATH THE MONUMENT. SET A U CHANNEL ALUMINUM POST WITH A FOREST SERVICE 54-9 MONUMENT SIGN, 1.0 FOOT NORTHERLY. NO ORIGINAL BEARING TREES IN THE VICINITY. MADE A NEW BEARING TREE, BASE BLAZE SCRIBED "BT", WITH 6" MAG SPIKE AND "PLS 7172" STAINLESS STEEL WASHER FOR CHAINING POINT AT BASE CENTER RIGHT SIDE, AND FOREST SERVICE 54-3 BEARING TREE SIGN:

BT1: AN 18 INCH THREE FORK JUNIPER, S46°W, 89.3 FEET

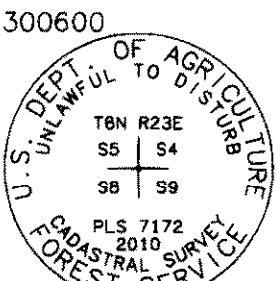

FOUND A RE-BAR AND PLASTIC CAP STAMPED "LS 4587" PER R3, 2.5 INCHES ABOVE THE GROUND. ACCEPTED AS THE TRUE CORNER AND REPLACED WITH A STANDARD US FOREST SERVICE ALUMINUM MONUMENT WITH A 3¼ INCH DIAMETER ALUMINUM CAP, STAMPED AS SHOWN, ON A 2½ INCH DIAMETER POST, 30 INCHES LONG, 24 INCHES IN THE GROUND, ENCIRCLED BY A MOUND OF STONES, 2.5 FEET IN DIAMETER AND 6 INCHES ABOVE THE GROUND. PLACED A PLASTIC ENCASED MAGNET BENEATH THE MONUMENT. BURIED THE FOUND RE-BAR AND PLASTIC CAP UPSIDE DOWN ALONGSIDE THE NEW MONUMENT. SET A U CHANNEL ALUMINUM POST WITH A FOREST SERVICE 54-9 MONUMENT SIGN, 1.5 FEET NORTHERLY. FOUND ORIGINAL BEARING TREES:

BT1: AN 18 INCH YELLOW PINE (RECORD WAS A 26 INCH FIR), N71°E, 79.2 FEET

BT2: A 6 INCH DEAD BUT STANDING MAHOGANY, S34°E, 139.2 FEET

ADDED, TO BT1, A FOREST SERVICE 54-3 BEARING TREE SIGN AND A 6" MAG SPIKE AND "PLS 7172" STAINLESS STEEL WASHER FOR A CHAINING POINT AT BASE CENTER RIGHT SIDE. MADE A NEW BEARING TREE, BASE BLAZE SCRIBED "BT", WITH 6" MAG SPIKE AND "PLS 7172" STAINLESS STEEL WASHER FOR CHAINING POINT AT BASE CENTER RIGHT SIDE, AND FOREST SERVICE 54-3 BEARING TREE SIGN:

BT3: A 10 INCH JUNIPER, S05°W, 30.8 FEET

MONUMENT DESCRIPTIONS:

300640

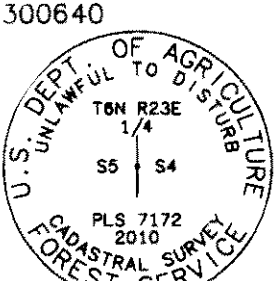

SEARCHED, FOUND NOTHING, ESTABLISHED BY SINGLE PROPORTION BETWEEN 300600 TO THE SOUTH AND 300700 TO THE NORTH, SET A STANDARD US FOREST SERVICE ALUMINUM MONUMENT WITH A 3¼ INCH DIAMETER ALUMINUM CAP, STAMPED AS SHOWN, ON A 2½ INCH DIAMETER POST, 30 INCHES LONG, 24 INCHES IN THE GROUND, ENCIRCLED BY A MOUND OF STONES, 2.5 FEET IN DIAMETER AND 6 INCHES ABOVE THE GROUND. PLACED A PLASTIC ENCASED MAGNET BENEATH THE MONUMENT. SET A U CHANNEL ALUMINUM POST WITH A FOREST SERVICE 54-9 MONUMENT SIGN, 1.2 FEET NORTHERLY. NO ORIGINAL BEARING TREES IN THE VICINITY. MADE NEW BEARING TREES, BASE BLAZE SCRIBED "BT", WITH 6" MAG SPIKE AND "PLS 7172" STAINLESS STEEL WASHER FOR CHAINING POINT AT BASE CENTER RIGHT SIDE, AND FOREST SERVICE 54-3 BEARING TREE SIGN:

BT1: AN 18 INCH JEFFREY PINE, N40°E, 13.4 FEET

BT2: A 24 INCH JEFFREY PINE, N16°W, 20.1 FEET

300700

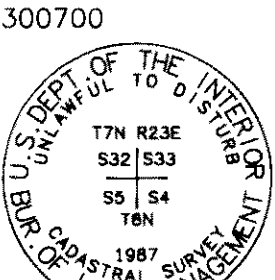

FOUND A 2½ INCH STAINLESS STEEL PIPE WITH A 3¼ BRASS CAP STAMPED AS SHOWN PER R4, ENCIRCLED IN A MOUND OF STONES, 4.0 FEET IN DIAMETER AND 12 INCHES ABOVE THE GROUND. FOUND A U CHANNEL ALUMINUM POST WITH A FOREST SERVICE 54-9 MONUMENT SIGN, 2.0 FEET EASTERLY. FOUND ORIGINAL BEARING TREES:

BT1: A 40 INCH JUNIPER, N16°W, 90.0 FEET

BT2: A 60 INCH JUNIPER, N49°E, 147.5 FEET

BT3: A 40 INCH DEAD AND FALLEN YELLOW PINE, S05°W, 268.6 FEET

FOUND 1987 BEARING TREES:

BT4: A 22 INCH JUNIPER, S12°E, 139.4 FEET

BT5: A 28 INCH JUNIPER, S27°W, 109.5 FEET

FOUND 2010 BEARING TREE PER R4:

BT6: A 6 INCH YELLOW PINE, N29°E, 81.2 FEET

ALL LIVE TREES HAVE A FOREST SERVICE 54-3 BEARING TREE SIGN AND A 6" MAG SPIKE AND "PLS 7172" STAINLESS STEEL WASHER FOR A CHAINING POINT AT CENTER RIGHT SIDE. THE 2010 BEARING TREE (BT6) IS BASE BLAZED AND SCRIBED "BT"

THIS MONUMENT SET BY CONCURRENT SURVEY AND SHOWN ON RECORD OF SURVEY NO. 32-87, RECORD OF SURVEY MAPS BOOK 5, PAGE 11.

340500

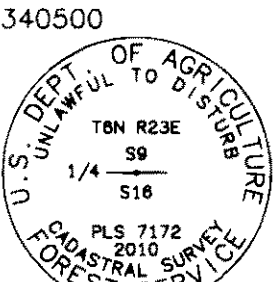

FOUND A 5/8 INCH RE-BAR WITH A PLASTIC CAP STAMPED "LS 4587" PER R3, 2 INCHES ABOVE THE GROUND, ACCEPTED AS THE TRUE CORNER AND REPLACED WITH A STANDARD US FOREST SERVICE ALUMINUM MONUMENT WITH A 3¼ INCH DIAMETER ALUMINUM CAP, STAMPED AS SHOWN, ON A 2½ INCH DIAMETER POST, 30 INCHES LONG, 24 INCHES IN THE GROUND, ENCIRCLED BY A MOUND OF STONES, 2.0 FEET IN DIAMETER AND 6 INCHES ABOVE THE GROUND. PLACED A PLASTIC ENCASED MAGNET BENEATH THE MONUMENT. BURIED THE FOUND 5/8 INCH RE-BAR UPSIDE DOWN ALONGSIDE THE NEW MONUMENT. SET A U CHANNEL ALUMINUM POST WITH A FOREST SERVICE 54-9 MONUMENT SIGN AND A FOREST SERVICE 54-2 BOUNDARY SIGN, 1.0 FOOT WESTERLY. NO ORIGINAL OR NEW BEARING TREES IN THE VICINITY.

340520

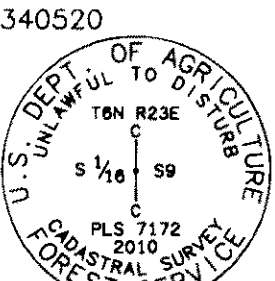

FOUND A 5/8 INCH RE-BAR AND PLASTIC CAP STAMPED "LS 4587" PER R3, 5 INCHES ABOVE THE GROUND ENCIRCLED BY A COLLAR OF STONES. ACCEPTED AS THE TRUE CORNER AND REPLACED WITH A STANDARD US FOREST SERVICE ALUMINUM MONUMENT WITH A 3¼ INCH DIAMETER ALUMINUM CAP, STAMPED AS SHOWN, ON A 2½ INCH DIAMETER POST, 30 INCHES LONG, 24 INCHES IN THE GROUND, ENCIRCLED BY A MOUND OF STONES, 2.5 FEET IN DIAMETER AND 6 INCHES ABOVE THE GROUND. PLACED A PLASTIC ENCASED MAGNET BENEATH THE MONUMENT. BURIED THE FOUND 5/8 INCH RE-BAR UPSIDE DOWN ALONGSIDE THE NEW MONUMENT. SET A U CHANNEL ALUMINUM POST WITH A FOREST SERVICE 54-9 MONUMENT SIGN AND A FOREST SERVICE 54-2 BOUNDARY SIGN, 1.0 FOOT NORTHWESTERLY. NO ORIGINAL OR NEW BEARING TREES IN THE VICINITY.

340600

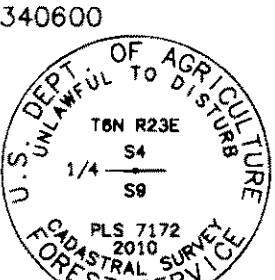

SEARCHED, FOUND NOTHING, ESTABLISHED BY SINGLE PROPORTION BETWEEN 300600 TO THE WEST AND 400600 TO THE EAST, SET A STANDARD US FOREST SERVICE 3¼ INCH DIAMETER ALUMINUM CAP, STAMPED AS SHOWN, ON A 2½ INCH DIAMETER POST, 30 INCHES LONG, 24 INCHES IN THE GROUND, ENCIRCLED BY A MOUND OF STONES, 2.0 FEET IN DIAMETER AND 6 INCHES ABOVE THE GROUND. PLACED A PLASTIC ENCASED MAGNET BENEATH THE MONUMENT. SET A U CHANNEL ALUMINUM POST WITH A FOREST SERVICE 54-9 MONUMENT SIGN, 1.0 FOOT EASTERLY. NO ORIGINAL BEARING TREES IN VICINITY. MADE NEW BEARING TREES, BASE BLAZE SCRIBED "BT", WITH 6" MAG SPIKE AND "PLS 7172" STAINLESS STEEL WASHER FOR CHAINING POINT AT BASE CENTER RIGHT SIDE, AND FOREST SERVICE 54-3 BEARING TREE SIGN:

BT1: A 6 INCH JEFFREY PINE, N18°E, 7.4 FEET

BT2: A 12 INCH JEFFREY PINE, S42°W, 11.5 FEET

MONUMENT DESCRIPTIONS:

340700

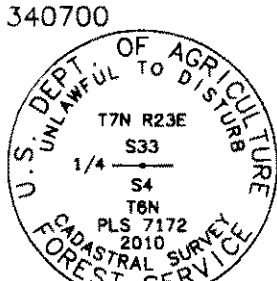

FOUND A STANDARD US FOREST SERVICE 3¼ INCH DIAMETER ALUMINUM CAP WITH MAGNET, STAMPED AS SHOWN, DRILLED INTO THE TOP OF A ROCK SHELF PER R4. FOUND A U CHANNEL ALUMINUM POST WITH FOREST SERVICE 54-9 MONUMENT SIGN, 2.0 FEET NORTHERLY. FOUND 2010 BEARING TREES WITH BASE BLAZE SCRIBED "BT", WITH 6" MAG SPIKE AND "PLS 7172" STAINLESS STEEL WASHER FOR CHAINING POINT AT CENTER RIGHT SIDE, AND FOREST SERVICE 54-3 BEARING TREE SIGN:

BT1: A 16 INCH PINYON PINE, S06°W, 6.7 FEET

BT2: A 24 INCH PINYON PINE, N06°W, 18.8 FEET

360520

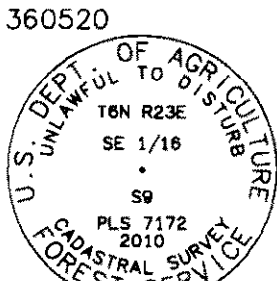

FOUND A 5/8 INCH RE-BAR WITH A PLASTIC CAP STAMPED "LS 4587" ENCIRCLED BY A MOUND OF STONES, 3.0 FEET IN DIAMETER AND 6 INCHES ABOVE THE GROUND. ACCEPTED AS THE TRUE CORNER AND REPLACED WITH A STANDARD US FOREST SERVICE ALUMINUM MONUMENT WITH A 3¼ INCH DIAMETER ALUMINUM CAP, STAMPED AS SHOWN, ON A 2½ INCH DIAMETER POST, 30 INCHES LONG, 24 INCHES IN THE GROUND, ENCIRCLED BY A MOUND OF STONES, 3.0 FEET IN DIAMETER AND 6 INCHES ABOVE THE GROUND. PLACED A PLASTIC ENCASED MAGNET BENEATH THE MONUMENT. BURIED THE FOUND 5/8 INCH RE-BAR UPSIDE DOWN ALONGSIDE THE NEW MONUMENT. SET A U CHANNEL ALUMINUM POST WITH A FOREST SERVICE 54-9 MONUMENT SIGN AND A FOREST SERVICE 54-2 BOUNDARY SIGN, 1.0 FOOT NORTHWESTERLY. NO ORIGINAL OR NEW BEARING TREES IN THE VICINITY.

360540

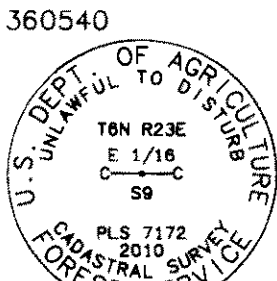

FOUND A 5/8 INCH RE-BAR WITH A PLASTIC CAP STAMPED "LS 4587" PER R3, FLUSH WITH THE GROUND. ACCEPTED AS THE TRUE CORNER AND REPLACED WITH A STANDARD US FOREST SERVICE ALUMINUM MONUMENT WITH A 3¼ INCH DIAMETER ALUMINUM CAP, STAMPED AS SHOWN, ON A 2½ INCH DIAMETER POST, 30 INCHES LONG, 26 INCHES IN THE GROUND, ENCIRCLED BY A MOUND OF STONES, 2.0 FEET IN DIAMETER AND 4 INCHES ABOVE THE GROUND. PLACED A PLASTIC ENCASED MAGNET BENEATH THE MONUMENT. BURIED THE FOUND 5/8 INCH RE-BAR UPSIDE DOWN ALONGSIDE THE NEW MONUMENT. SET A U CHANNEL ALUMINUM POST WITH A FOREST SERVICE 54-9 MONUMENT SIGN AND A FOREST SERVICE 54-2 BOUNDARY SIGN, 1.0 FOOT WESTERLY. NO ORIGINAL BEARING TREES IN THE VICINITY. MADE NEW BEARING TREES, BASE BLAZE SCRIBED "BT", WITH 6" MAG SPIKE AND "PLS 7172" STAINLESS STEEL WASHER FOR CHAINING POINT AT BASE CENTER RIGHT SIDE, AND FOREST SERVICE 54-3 BEARING TREE SIGN:

BT1: A 14 INCH JEFFREY PINE, S34°W, 78.7 FEET

BT2: A 26 INCH JEFFREY PINE, S79°W, 48.9 FEET

360560

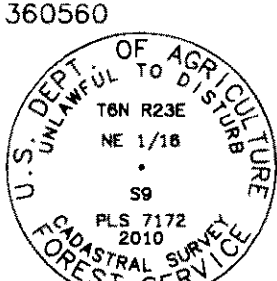

FOUND A MAG NAIL AND WASHER IN THE ASPHALT SURFACE OF HIGHWAY 395, IN LIEU OF A SPIKE AND WASHER STAMPED "LS 4587" PER R3, APPROXIMATELY 5 FEET EAST OF THE WESTERLY EDGE OF THE PAVEMENT. ACCEPTED AS THE TRUE CORNER AND REPLACED WITH A STANDARD US FOREST SERVICE 3¼ INCH DIAMETER ALUMINUM CAP WITH MAGNET, STAMPED AS SHOWN, ON A 2½ INCH DIAMETER IRON PIPE 2 INCHES BELOW THE ASPHALT SURFACE. NO ORIGINAL BEARING TREES IN THE VICINITY. MADE NEW BEARING TREES, BASE BLAZE SCRIBED "BT", WITH 6" MAG SPIKE AND "PLS 7172" STAINLESS STEEL WASHER FOR CHAINING POINT AT BASE CENTER RIGHT SIDE, AND FOREST SERVICE 54-3 BEARING TREE SIGN:

BT1: A 24 INCH JEFFREY PINE, S75°E, 64.2 FEET

BT2: A 24 INCH JEFFREY PINE, N04°W, 112.5 FEET

360600WC

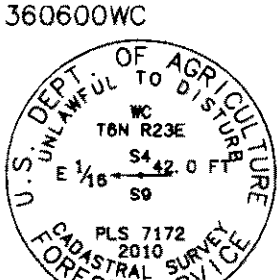

TRUE CORNER FALLS ON A DANGEROUS ROCK OUTCROP AND WAS NOT SET, ESTABLISHED A WITNESS CORNER 42.00 FEET EASTERLY ALONG THE SECTION LINE, SET A STANDARD US FOREST SERVICE 3¼ INCH DIAMETER ALUMINUM CAP WITH MAGNET, STAMPED AS SHOWN, DRILLED AND CEMENTED INTO THE TOP OF A 6 FOOT BY 6 FOOT BY 4 FOOT GRANITE BOULDER. SET A U CHANNEL ALUMINUM POST WITH A FOREST SERVICE 54-9 MONUMENT SIGN AND A FOREST SERVICE 54-2 BOUNDARY SIGN, 1.5 FEET SOUTHERLY. NO ORIGINAL OR NEW BEARING TREES IN THE VICINITY.

360620WC

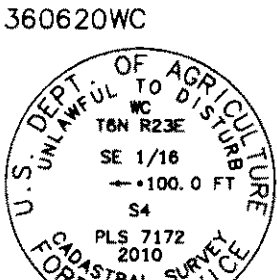

TRUE CORNER FALLS IN THE WEST WALKER RIVER AND WAS NOT SET, ESTABLISHED A WITNESS CORNER 100.00 FEET EASTERLY ALONG THE EAST-WEST CENTER QUARTER LINE, SET A STANDARD US FOREST SERVICE ALUMINUM MONUMENT WITH A 3¼ INCH DIAMETER ALUMINUM CAP, STAMPED AS SHOWN, ON A 2½ INCH DIAMETER POST, 30 INCHES LONG, 26 INCHES IN THE GROUND, ENCIRCLED BY A MOUND OF STONES, 2.0 FEET IN DIAMETER AND 4 INCHES ABOVE THE GROUND. PLACED A PLASTIC ENCASED MAGNET BENEATH THE MONUMENT. SET A U CHANNEL ALUMINUM POST WITH A FOREST SERVICE 54-9 MONUMENT SIGN AND A FOREST SERVICE 54-2 BOUNDARY SIGN, 1.0 FOOT NORTHERLY. NO ORIGINAL OR NEW BEARING TREES IN THE VICINITY.