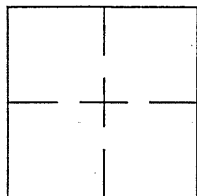

## CORNER RECORD

Document Number CR 5707City of OAKLANDCounty of ALAMEDA, CaliforniaBrief Legal Description IRON PIN MONUMENT LOCATED WITHIN THE INTERSECTION OF SKYLINE BOULEVARD AND REDWOOD ROAD. (13NE2-R)

## CORNER RECORD

Government Corner ☐ Control ☒  
 Meander ☐ Property ☐  
 Rancho ☐ Other ☐  
 Date of Survey 05/15/13

COORDINATES  
(Optional)

N. \_\_\_\_\_  
 E. \_\_\_\_\_  
 Zone \_\_\_\_\_ Datum \_\_\_\_\_  
 Elev. \_\_\_\_\_

Corner — Left as found ☒ Found and tagged ☐ Established ☐ Reestablished ☐ Rebuilt ☐

Identification and type of corner found: Evidence used to identify or procedure used to establish or reestablish the corner:  
FOUND IRON PIN MONUMENT LOCATED WITHIN THE INTERSECTION OF SKYLINE BOULEVARD  
AND REDWOOD ROAD.

AS SHOWN ON CITY OF OAKLAND MONUMENT MAP, PAGE 193.

THIS POINT WAS REFERENCED PRIOR TO A CONSTRUCTION PROJECT IN THE VICINITY.

A description of the physical condition of the monument as found and as set or reset: \_\_\_\_\_

FOUND AND SET POINTS AS SHOWN ON PAGE 2.

THESE TIES ARE FOR THE PURPOSE OF PERPETUATING THE FOUND MONUMENTATION.

NO CLAIM IS MADE AS TO THE RELATIONSHIP OF THE POINTS OR LINES SHOWN HEREON  
TO TRUE BOUNDARY LOCATIONS.

## SURVEYOR'S STATEMENT

This Corner Record was prepared by me or under my direction in conformance with  
 the Land Surveyors' Act on JUNE 14, 2013.

Signed Vincent H. Cunha L.S. Number LS 4520  
VINCENT H. CUNHA



## COUNTY SURVEYOR'S STATEMENT

This Corner Record was received 6-26-13 and examined

and filed 8-1-2013

Signed Russell R. Penland Title COUNTY SURVEYOR

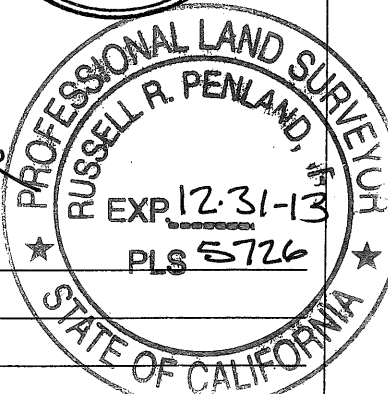

County Surveyor's Comment \_\_\_\_\_

# LEGEND

- FOUND IRON PIN IN MONUMENT WELL (13NE2-R)
- ⊙ FOUND MONUMENT AS NOTED
- ✕ SET CUT CROSS IN CONCRETE
- AA##A# ALAMEDA COUNTY MONUMENT ID

SCALE: 1"=30'

