

CORNER RECORD

City of BERKELEY

Brief Legal Description CITY OF BERKELEY MONUMENT B0689

BK 49 PG 70
Document Number CR 5442
County of ALAMEDA, California

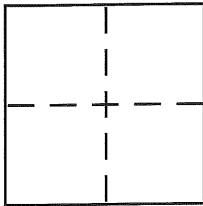

CORNER TYPE

Government Corner ☐ Control ☒
Meander ☐ Property ☐
Rancho ☐ Other ☐
Date of Survey MARCH 8, 2013

COORDINATES (Optional)

N. _____
E. _____
Zone _____ NAD27 ☐ NAD83 ☐
NAD83 Epoch _____
Elev. _____
Vert. Datum: NGVD29 ☐ NAVD88 ☐
Meas. Units: Metric ☐ Imperial ☐

Corner - Left as found ☒ Found and tagged ☐ Established ☐ Reestablished ☐ Rebuilt ☐

Identification and type of corner found: Evidence used to identify or procedure used to establish or reestablish the corner:
IN COMPLIANCE WITH SECTION 8771 OF THE PROFESSIONAL LAND SURVEYORS' ACT, THIS CORNER
RECORD IS BEING FILED TO ESTABLISH THE POSITION OF AN EXISTING MONUMENT PRIOR TO STREET
RECONSTRUCTION. (SEE PAGE 2)

A description of the physical condition of the monument as found and as set or reset:
CITY OF BERKELEY STANDARD WELL-TYPE MONUMENT, FOUND IN GOOD CONDITION. (SEE PAGE 2)

SURVEYOR'S STATEMENT

This Corner Record was prepared by me or under my direction in conformance with
the Land Surveyor's Act on MARCH 18, 2013

Signed [Signature] P.L.S. or R.C.E. No. 5003

COUNTY SURVEYOR'S STATEMENT

This Corner Record was received 3-27-13

and examined and filed 6-6-2013

Signed [Signature] P.L.S. or R.C.E. No. 5726

Title COUNTY SURVEYOR

County Surveyor's Comment _____

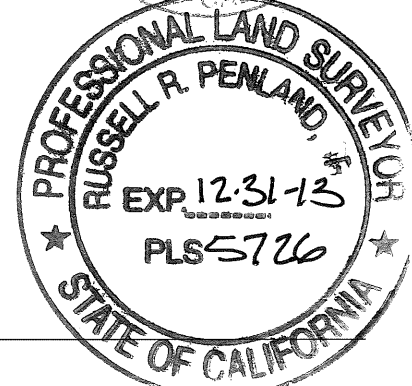
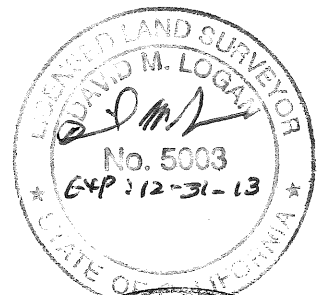

WH94J3

LEGEND

⊙ 1/4" BRASS PIN CITY MONUMENT IN
STANDARD MONUMENT WELL

+ SET REFERENCE CROSS

⊕ SET MAG NAIL

NOTE:

THE EXISTING MONUMENT AS SHOWN IS
REFERENCED BY STRAIGHT LINES BETWEEN
RP-1 TO RP-3 AND RP-2 TO RP-4.

