

Swamp and Overflowed Lands

County Surveyors Office  
Stanislaus County

Survey No 156 Resurvey of a portion of No 141.

Township 6 South

Range 7 East

Section 6 all between the United States

Meander line and the Right bank of  
the San Joaquin River in the North  $\frac{1}{2}$  of  
the South  $\frac{1}{2}$  and the South  $\frac{1}{2}$  of the North  
 $\frac{1}{2}$  of Section 6

Base and Meridian of Mount Diablo

Containing 37.08 acres

Surveyed April 23<sup>d</sup> 1861

for John Summers

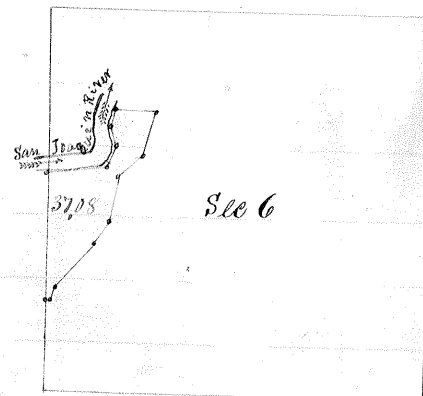

Scale  $\frac{1}{2}$  Mile to 1 inch

### Field Notes

Beginning at the South West corner of the North West  $\frac{1}{4}$  of the South West  $\frac{1}{4}$  of Section 6. Run on Section line North 27.00 chs, to the Right bank of the San Joaquin River Meander down Stream Run N 82° E 13.24 chs, N 79° E 4.00 chs, North 4.25 chs, N 42° E 3.00 chs, to  $\frac{1}{4}$  Section line in the North  $\frac{1}{2}$  of Section 6 Run on  $\frac{1}{4}$  Section line East 8.50 chs, to the U. S. Meander line Run on the U. S. Meander line S 15° W 0.07 chs, S 07° W 0.30 chs, S 62° W 10.80 chs, S 42° W 5.00 chs, S 70° E 12.50 chs, S 26° E 13.18 chs, to  $\frac{1}{4}$  Section line in the South  $\frac{1}{2}$  of Section 6 Run on  $\frac{1}{4}$  Section line West, 7 chs to the place of beginning. The above was embraced in Survey No 141 Made February 22<sup>d</sup> 1860 for Wm P Grenfell

Run by the True Meridian Magnetic Variation 16° 15' East

Surveyed in accordance with the Act of the Legislature concerning Swamp and Overflowed lands approved April 18<sup>th</sup> 1852 and the instructions of the Surveyor General

Silas Wilcox

County Surveyor Stanislaus County

Approved May 7<sup>th</sup> 1861

N. A. Higley

Surveyor General

Recorded May 31<sup>st</sup> 1861

Silas Wilcox

County Surveyor